

How To... Use A Laptop Lock

Hypertec How To Guides: Accessories

Laptop locks are a great visual deterrent for potential thieves, and will protect a laptop (or other equipment) in the office, home, or other working location.

1. Loop the cable round solid fixing point; such as a heating pipe, desk leg, or other piece of solid furniture.
2. Feed cable through loop at end, to secure it into place.
3. Insert lock into Notebook (or other equipment's) security slot.
4. Push key into lock.
5. Turn key until lock has fixed into place.
6. Remove key and release lock.
7. Keep key in a safe place.



CubeByte Laptop Lock



With 2 keys, cable, and security loop

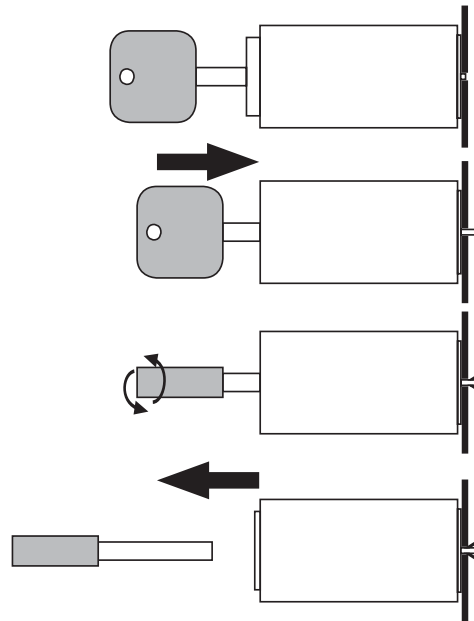

Loop around secure fixing point



Lock into machine

Hypertec's sales and product management team is always available to give you advice on physical security, simply contact us as below.

Hypertec products are chosen to be simple to use, and of a high quality which should give you no trouble. However if you need advice, assistance, or are experiencing problems, simply contact the Hypertec Technical Support team on 0870 243 5603, between 8.30am - 6pm, Monday-Friday.

Please contact us for more information:

Hypertec Ltd

t: 0870 243 5603

w: www.hypertec.co.uk