

HSTP3T10KEBC/HSTP3T15KEBC
 HSTP3T20KEBC/HSTP3T30KEBC
 HSTP3T40KEBC

3-PHASE ONLINE UPS TO ACHIEVE POWER REDUNDANCY

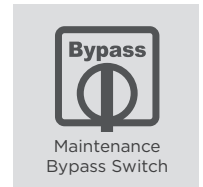
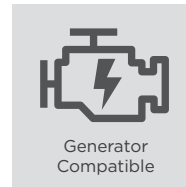
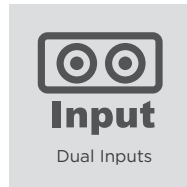
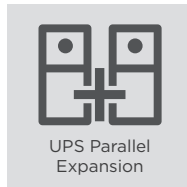
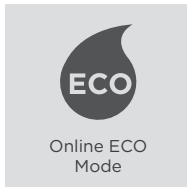
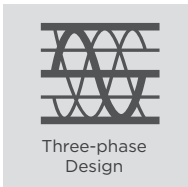

The 3-Phase UPS with parallel expansion capability to achieve N+X power redundancy for enterprise applications

Designed for server room and data center applications, the HSTP3T (3-Phase) Series adopts double-conversion topology to provide seamless pure sine wave output. The products also adopt ECO Mode to save on energy costs, Smart Battery Management (SBM) to extend battery lifespan, and multifunction LCD readout to display precise information. The power management software allows users to easily control and monitor the UPS system.

SERIES FEATURES

- Three-phase Design
- Online (Double Conversion) UPS Topology
- Online ECO Mode
- UPS Parallel Expansion
- Dual Inputs
- Generator Compatible
- Pure Sine Wave Output
- Overload Protection
- Maintenance Bypass Switch
- LCD Status Display
- Emergency Power Off (EPO) Port
- PowerPanel® Management Software

PRODUCT CALLOUTS

1. Emergency Power Off (EPO) Button
2. LED Status Indicator
3. LCD Display Panel
4. Function Buttons
5. Maintenance Bypass Switch
6. Battery Circuit Breaker
7. Bypass Input Circuit Breaker
8. Output Circuit Breaker
9. RS232
10. RS485
11. SNMP/HTTP Network Slot
12. Parallel Board Slot
13. Main Input Circuit Breaker

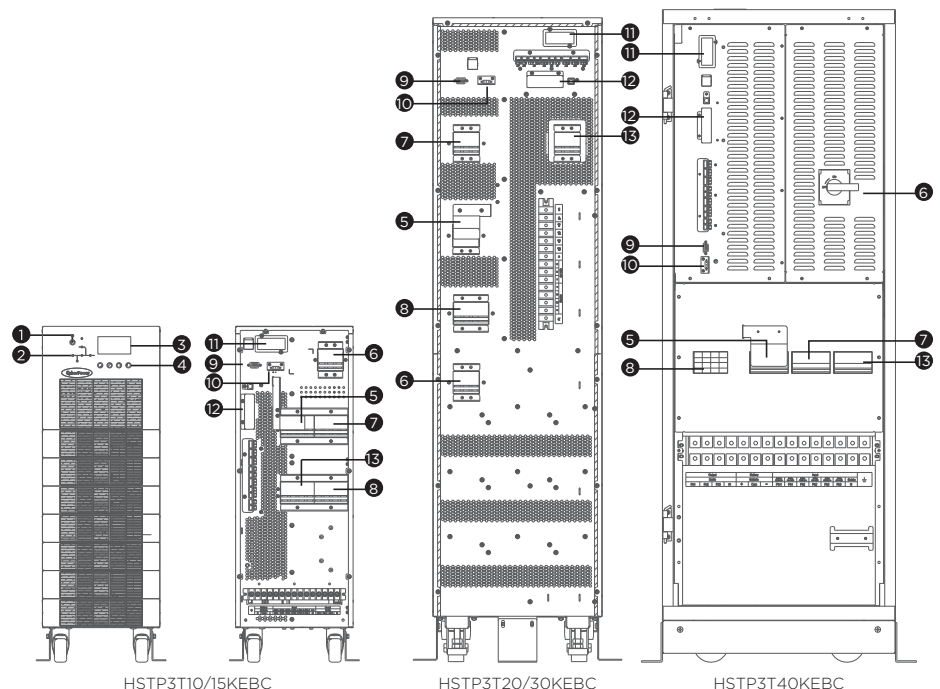



TECHNICAL SPECIFICATIONS

Model Name	HSTP3T10KEBC	HSTP3T15KEBC	HSTP3T20KEBC	HSTP3T30KEBC	HSTP3T40KEBC
General					
Phase	Three Phase				
Form Factor	Tower				
Energy Saving Technology	Online ECO Mode Efficiency up to 98%				
Normal Mode Efficiency (%)	95%				
Battery Mode Efficiency (%)	95%				
Parallel Expansion (Max. Units)	4				
Input					
Dual Power Inputs	Yes				
Nominal Input Voltage (Vac)	Line to Neutral (L-N): 220, 230, 240 Vac, Line to Line (L-L): 380, 400, 415 Vac				
Input Voltage Range (Vac)	Line to Neutral (L-N): 132 - 276 Vac, Line to Line (L-L): 228 - 478 Vac				
Input Frequency (Hz)	50 ± 3, 60 ± 3				
Input Frequency Range (Hz)	40 - 70				
Input Power Factor	0.99				
Output					
Capacity (VA)	10000	15000	20000	30000	40000
Capacity (Watts)	9000	13500	18000	27000	36000
Rated Output Voltage (Vac)	Line to Neutral (L-N): 220, 230, 240 Vac, Line to Line (L-L): 380, 400, 415 Vac				
Output Voltage Tolerance (%)	1.50%				
Output Frequency (Hz ± %)	50 ± 0.1, 60 ± 0.1				
Power Factor	0.9				
Overload Protection (Line Mode)	105-110% Load for 60 min, 110-125% Load for 10 min, 125-150% Load for 1 min, >150% Load Immediately				
Crest Factor	3:1				
Harmonic Distortion (Linear Load)	THD<1%				
Harmonic Distortion (Non-linear Load)	THD<5.5%				
Battery					
Runtime at Half Load (min)	25	18	18	9	18
Runtime at Full Load (min)	12	5	5.5	2	5
Recharge Power (%)	Default 10% (Selectable from 1-20% x UPS Capacity)				
Charger Voltage Tolerance (%)	1%				
Battery Type	VRLA				
Battery Solution	Internal Battery				
Battery Quantity (pcs)	40				80
Battery Voltage (V)	±240				
Single Battery Capacity (AH)	12 V 9 AH		12 V 12 AH		
Management & Communications					
LCD Panel	Yes				
LCD Information Display	Operation Type, Power Status, Battery Status, Load Status, Fault & Warning, Other Information, Event & Log				
LCD Setting & Control	Mode Setting, Input & Output, Battery Setting, Communication, Event & Log, Security Setting, Language				
LED Indicators	Yes				
Serial Port	RS232 x 1 + RS485 x 1 + Dry Contact x1				
Dry Contact (with Relay)	Yes				
Emergency Power Off (EPO) Port	Yes				
Power Management Software	PowerPanel® Business (Recommended)				
SNMP/HTTP Remote Monitoring	Yes - with optional RMCARD205				
Physical					
Ingress Protection	IP20				
Physical Size					
Dimensions (WxHxD) (mm.)	250 x 715 x 840		350 x 1335 x 738		500 x 1400 x 840
Weight (kg.)	164		247		456
Environmental					
Operating Temperature (°C)	0 - 40				
Operating Relative Humidity (Non-condensing) (%)	0 - 95				
Operating Elevation (feet/meters)	≤1000, Load Derated 1% per 100m from 1000m and 2000m				
Storage Temperature (°C)	-40 - 70				
Storage Relative Humidity (Non-condensing) (%)	0 - 95				
Audible Noise at 1M from Surface of Unit (dB)	58				
Certifications					
Certifications*	CE, IEC62040-1, IEC62040-2				

*Certifications may vary according to different regions. Visit www.cyberpower.com for more information.
#All specifications are subject to change without notice.